

NOTES:

- 1 THIS AREA IS RESERVED FOR CONTACTS.
- 2 DIRECTION OF KINK OPTIONAL.
- 3 PRODUCT SPECIFICATION: 108-19052

DO NOT SCALE  
DIMENSIONS IN mm

METRIC

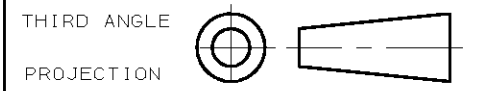

PARTNUMBERS BOX PACKAGING	PARTNUMBERS REEL PACKAGING	NUMBER OF POSITIONS	"A"	"B"
7-100400-4	0-100400-4	4	3,81	7,1
7-100400-6	0-100400-6	6	6,35	9,7
7-100400-8	0-100400-8	8	8,89	12,2
8-100400-0	1-100400-0	10	11,43	14,7
8-100400-2	1-100400-2	12	13,97	17,3
8-100400-4	1-100400-4	14	16,51	19,8
8-100400-6	1-100400-6	16	19,05	22,4
8-100400-8	1-100400-8	18	21,59	24,9
9-100400-0	2-100400-0	20	24,13	27,4

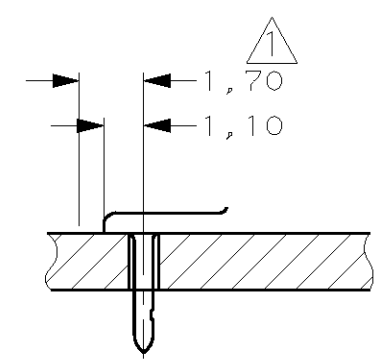
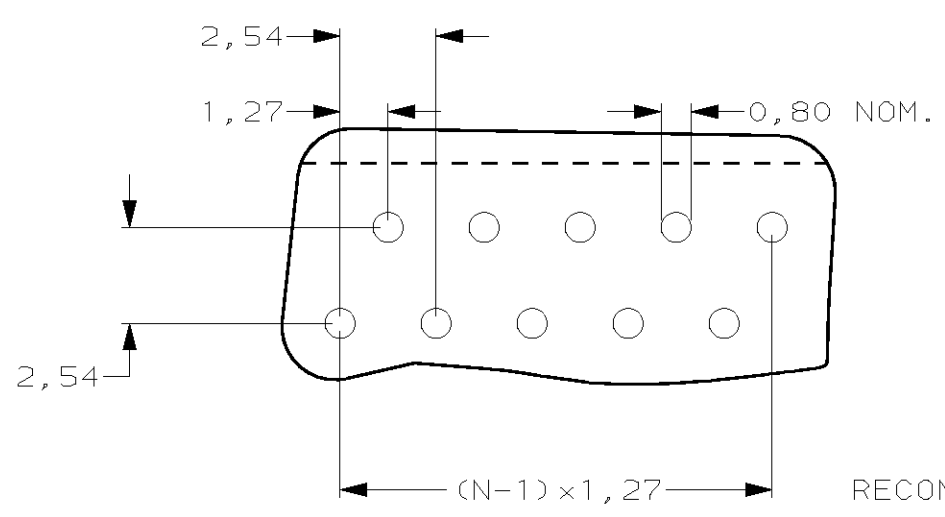
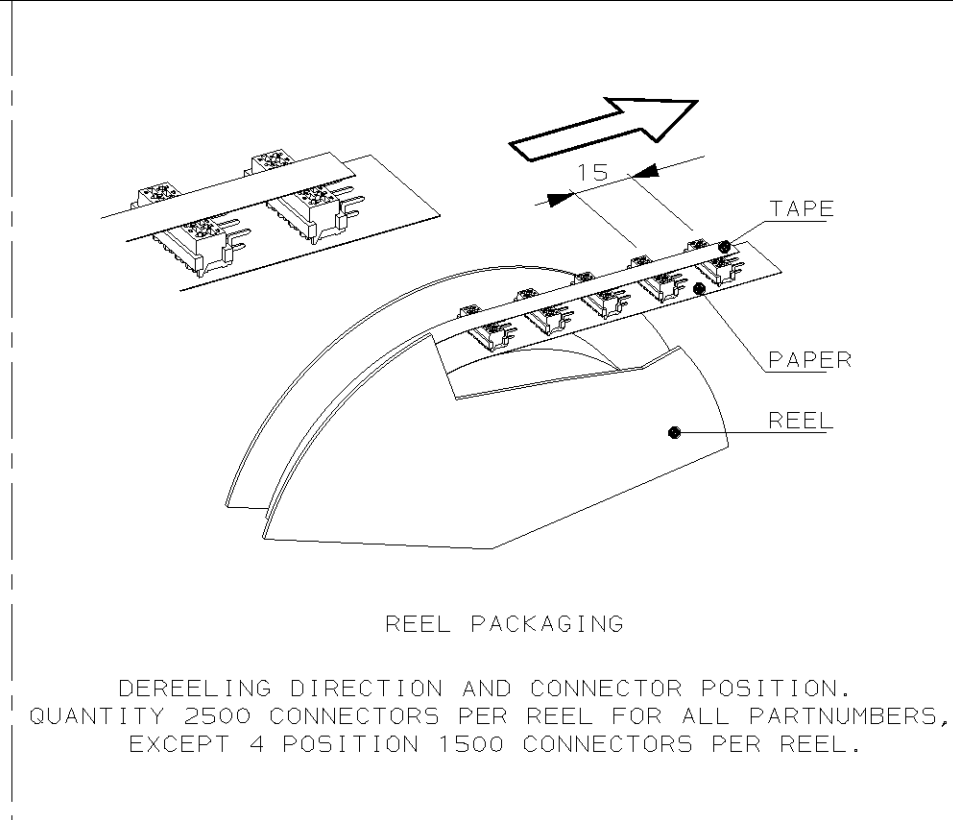
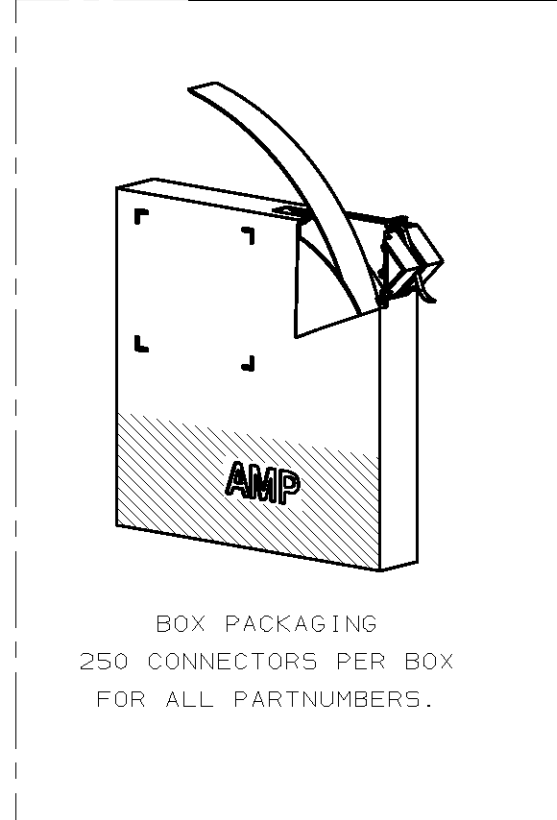
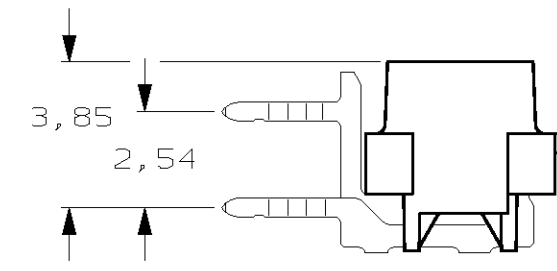
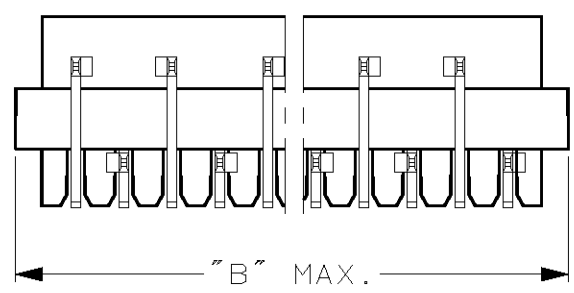
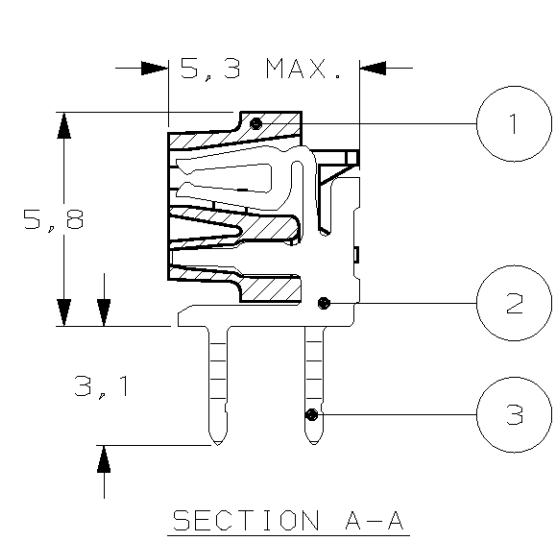
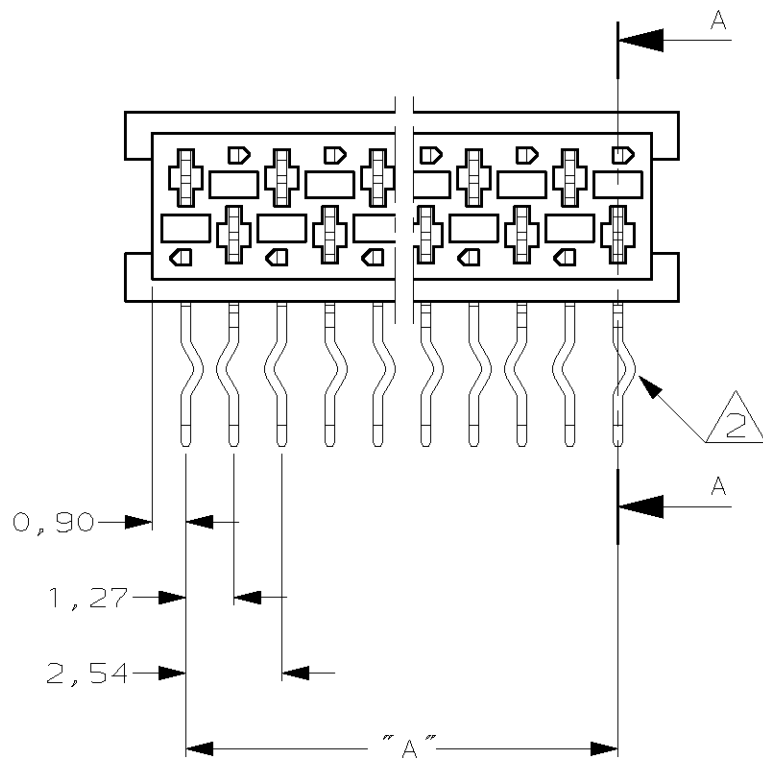

FINISH	MATERIAL	DESCRIPTION	ITEM
TIN OVER NICKEL PLATING.	PHOSPHORBRONZE	FEMALE CONTACT	3
TIN OVER NICKEL PLATING.	PHOSPHORBRONZE	FEMALE CONTACT	2
	GLASS FILLED POLYESTER (RED)	HOUSING	1

LTR.	REVISION RECORD	DR.	CHK.	DATE
G	EHC0-0337-04	JvdH	EL	17 JUN 04
F	EH01-0232-04	JvdH	EL	16 FEB 04
E	EH01-0506-03	JvdH	RV	24 JUN 03

**CUSTOMER DRAWING** FOR REFERENCE ONLY WILL NOT BE UPDATED

© COPYRIGHT 19- BY AMP-HOLLAND B.V.  
ALL INTERNATIONAL RIGHTS RESERVED. AMP PRODUCTS MAY BE COVERED BY U.S. AND FOREIGN AND/OR PATENTS PENDING.  
THIS DRAWING IS UNPUBLISHED RELEASED FOR PUBLICATION

**AMP** AMP-HOLLAND B.V.  
's-Hertogenbosch, The Netherlands.

NAME: Micro-MaTch FEMALE ON BOARD  
SIDE ENTRY WITHOUT POLARIZATION

DR.: J. V. DREUMEL	CHK.: H. KOKKEN	APP.: -	DWG.No. 100400	REV.LTR. G	SHEET 1 OF 1	A3
DATE: 29-10-1991	DATE: 29 OCT 1991	DATE: -				